

DISCOVER LONDON'S CASTLE

The Tower of London is a 1,000-year-old castle that protects the Crown Jewels. It was a secure fortress, a royal palace and an infamous prison. Kings and queens demonstrated their power from here, shaping society and influencing our world.

MAP

TOWER OF LONDON

SPACE TO STIR AND BE STIRRED
TOWER OF LONDON • HAMPTON COURT PALACE • BANQUETING HOUSE
KENSINGTON PALACE • KEW PALACE • HILLSBOROUGH CASTLE AND GARDENS

POWER AND GLORY

See how this mighty castle has always protected the nation's treasure. This secure fortress still guards the Crown Jewels today, and is home to the Royal Armouries.

Explore three sides of the Tower's amazing story

FORTRESS

ROYALS AND RAVENS

Step into the luxurious palace of Kings and Queens and home to their exotic animals. Meet the Yeoman Warders and ravens, the historic guardians of the Tower.

PALACE

MYTH AND MURDER

Experience the places where people were imprisoned while awaiting torture, death or punishment. Discover the graffiti prisoners left behind and hear of their daring escapes.

PRISON

TOP THINGS TO SEE AND DO

FORTRESS
PALACE
PRISON



MEET THE YEOMAN WARDERS

THE RAVENS



Battlements

WHITE TOWER



© Royal Armouries

Imprisonment at the Tower



Royal Beasts

ACCESS ALL ERAS WITH MEMBERSHIP

Prices start from £59. Upgrade your ticket on site, join at hrp.org.uk/membership or scan the QR code



- toweroflondon
- historicroyalpalaces
- @TowerofLondon
- #toweroflondon

VISIT OUR WEBSITE FOR MORE INFORMATION
HRP.ORG.UK

PLEASE HELP US

Historic Royal Palaces is a registered charity. We generate all our own funds, and the pandemic has had a devastating impact on our finances.

You can help us to care for the palaces by joining as a member or making a donation.

Text **RAVENS** to **70085** to donate £5 and help us to keep the spirit of the Tower of London alive

Texts cost £5 plus one standard rate message



Registered charity no. 1068852

CROWN JEWELS

Tower Executions

TORTURE AT THE TOWER



© British Library

Medieval Palace



FR
La Tour de Londres est un château vieux de 10 siècles, qui protège les Joyaux de la Couronne. Ce fut une forteresse défensive, un palais royal, et une prison tristement célèbre. C'est de là que les rois et les reines manifestaient leur pouvoir, façonnaient la société et influençaient notre monde.

DE
Der Tower of London ist eine 1000 Jahre alte Burg, in der die Kronjuwelen aufbewahrt werden. Im Verlauf der Geschichte hat er als sichere Festung, königlicher Palast und berüchtigtes Gefängnis gedient. Königinnen und Könige haben von hier aus ihre Macht ausgeübt, die Gesellschaft geprägt und unsere Welt beeinflusst.

ES
La Torre de Londres es un castillo de 1000 años de antigüedad en el que se custodian las Joyas de la Corona. Ha sido una fortaleza inexpugnable, un palacio real y una cárcel tristemente célebre. Desde aquí, reyes y reinas han ejercido su poder, fraguando la sociedad y dejando su huella en el mundo.

IT
La Torre di Londra è un castello millenario, sede dei Gioielli della Corona inglese. Una fortezza sicura, un palazzo reale e una prigione malfamata, da dove re e regine esercitarono tutto il loro potere, modellando la società e influenzando i nostri tempi.

PT
A Torre de Londres é um castelo com 1000 anos que protege as Joias da Coroa. Foi uma fortaleza segura, um palácio real e uma famosa prisão. Reis e rainhas demonstraram o seu poder a partir daqui, modelando a sociedade e influenciando o nosso mundo.

RU
Лондонский Тауэр — это замок с тысячелетней историей, в котором хранятся сокровища Британской короны. Он был и неприступной крепостью, и королевским дворцом, и печально знаменитой тюрьмой. Отсюда короли и королевы правили судьбами империи и всего мира.

PL
Tower of London to 1000-letnia twierdza, w której chronione są klejnoty koronne. Pełniła funkcję fortecy, królewskiego pałacu i owianego złą sławą więzienia. Dla królów i królowych twierdza stanowiła symbol ich siły oraz narzędzie kształtowania społeczeństwa i wywierania wpływu na świat.

CN
伦敦塔是一座具有1000年历史的城堡，用于保卫王冠。它是一座森严的要塞，一所皇家宫殿，还是一处恶名昭著的监狱。国王和女王从这里昭示王权，塑造社会并影响全世界。

JP
ロンドン塔はクラウン・ジュエルズを守る1000年の歴史を持つ古い城です。それは堅固な砦であり、王家の宮殿であり、忌まわしい監獄でもありました。王たち、女王たちはここから彼らの権力を示し、それによって社会を形成し、私たちの世界に影響を与えたのです。

BN
Tower of London (টাওয়ার অফ লন্ডন) একটি 1000 বছর পুরানো কেল্লা যেটি রাজমুকুটের রত্নগুলিকে রক্ষা করে। এটি একটি নিরাপদ দুর্গ, একটি রাজকীয় প্রাসাদ, এবং একটি কথ্যাত কারাগার ছিল। রাজা আর রানীগণ এখান থেকে তাদের ক্ষমতা প্রদর্শন, সমাজ রূপায়ণ এবং আমাদের বিশ্বকে প্রভাবিত করেছেন।

FORTRESS

 Crown Jewels **1**



 White Tower **2**



 Battlements **3**

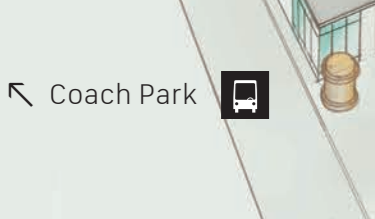
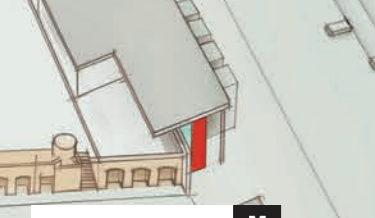

 Yeomen Warders **4**



EXPLORE THREE SIDES OF THE TOWER'S AMAZING STORY FORTRESS PALACE PRISON



PALACE

 The Ravens **5**



 Medieval Palace **6**



 Royal Beasts **7**



PRISON

 Torture at the Tower **8**





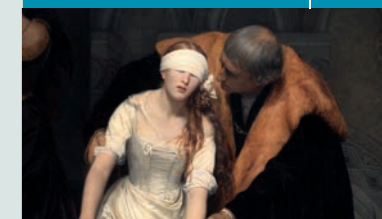









 Tower Executions **9**

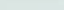

 Bloody Tower **10**

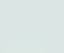

- MAP KEY**
-  Information
 -  Multimedia guides
 -  Female toilet
 -  Male toilet
 -  Accessible toilet
 -  Baby changing
 -  Accessible via Radar key
 -  Accessible entrance
 -  Shop
 -  Café
 -  Restaurant
 -  Buggy park
 -  No photography